

GRUPPOLUBE

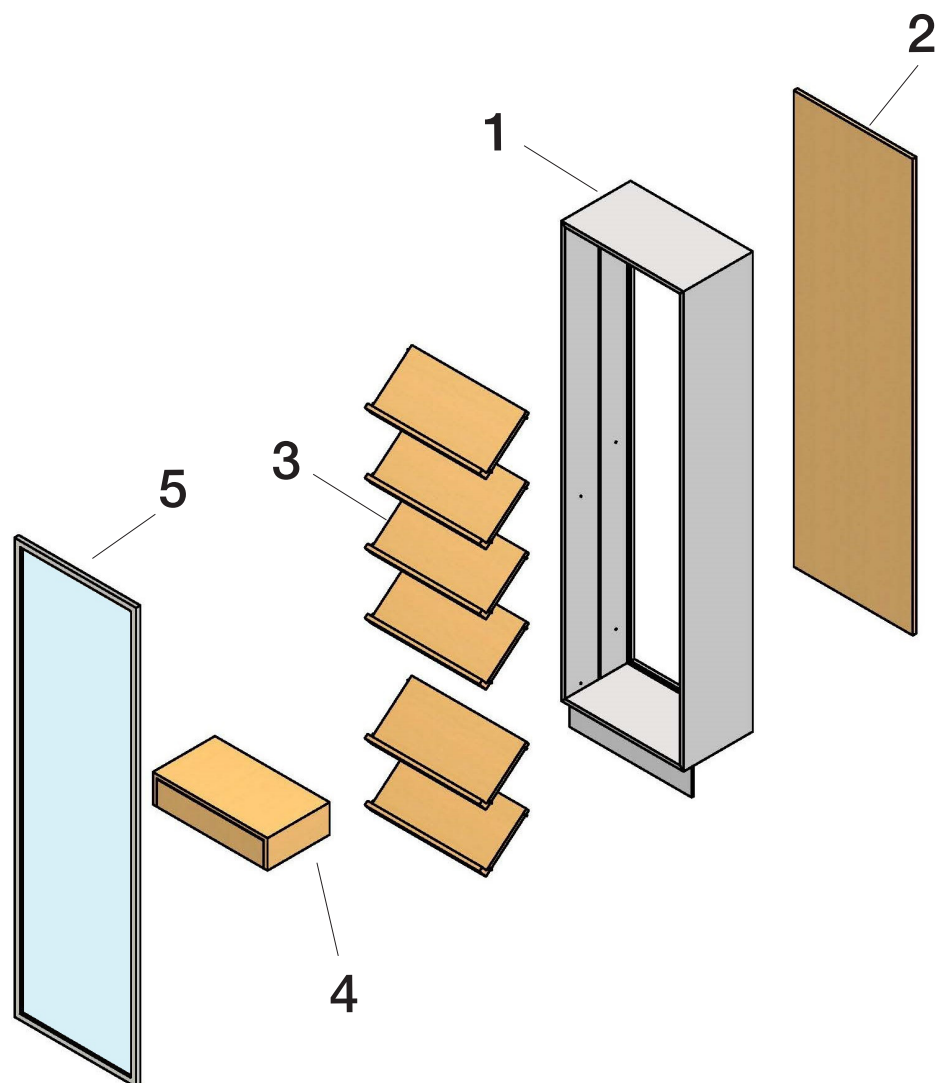

MOBILI CANTINETTA WINE

2024



- **PROFONDITÀ 340 mm**
DEPTH 340 mm
- **STRUTTURA ESTERNA SPESSORE 18 mm (in melaminico)**
EXTERNAL STRUCTURE THICKNESS 18 mm (in melamine)
- **REALIZZATI IN FOLDING**
PRODUCED IN FOLDING
- **SCHIENA SPESSORE 18 mm (disponibile anche a contrasto)**
BACK PANEL THICKNESS 18 mm (also available in contrasting colour)
- **RIPIANI VELETTA IN MELAMINICO (in tinta con la struttura)**
MELAMINE VEIL SHELVES (in the same colour as the structure)
- **RIPIANI RIMOVIBILI (per permettere il montaggio delle luci)**
REMOVABLE SHELVES (to allow the assembly of lights)
- **ANTA TELAIO ALLUMINIO SP. 22 CON CERNIERE A SCOMPARSA**
ALUMINIUM FRAME DOOR THICKNESS 22 WITH CONCEALED HINGES
- **CASSETTO ESTRAIBILE BLUMOTION PROF. 270 mm A FILO INTERNO (in tinta con la schiena)**
BLUMOTION PULL-OUT DRAWER, 270 mm DEPTH INTERNAL FLUSH (matching the back panel)

1: Cielo, fondo e fianchi folding
Sky, bottom and sides folding

4: Box con cassetto estraibile
Box with pull-out drawer

2: Schiena
Back panel

5: Anta alluminio
Aluminium door

3: Ripiani veletta
Veil shelves

Dettaglio anta "QUADRA" "QUADRA" door detail



Anta con telaio sp.22
Door with frame 22 mm thick



Particolare presa maniglia ricavata all'interno dei quattro lati dell'anta.
Detail of the handle grip designed inside the four sides of the door.

Finiture telaio Frame finishes

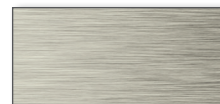

titanio (opz.QTIT)

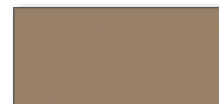

ottone (opz.QOTT)



umber (opz.QUMB)



rame brunito (opz.QRAM)

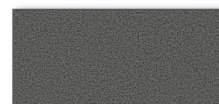

silver dark (opz.QDAR)



nero (opz.QNER)

Finiture vetro Glass finishes

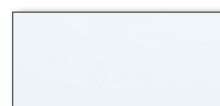

trasparente

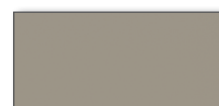

bronzo

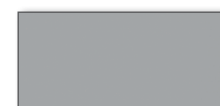

fumè

PARTICOLARE FERRAMENTA UTILIZZATA DETAIL OF HARDWARE USED

CERNIERA A SCOMPARSA HIDDEN HINGE

DETTAGLIO CERNIERA IN ACCIAIO DISPONIBILE IN DUE
COLORAZIONI: NICHEL SATINATO, BRUNITO.
INCASSATE NEL FONDO E CIELO DEL MOBILE CON REGOLAZIONE
DALL'INTERNO.

DETAIL OF STEEL HINGE AVAILABLE IN TWO COLORS: SATIN NICKEL, BURNISHED.
RECESSED IN THE BOTTOM AND TOP OF THE CABINET WITH ADJUSTMENT
FROM THE INSIDE.



CASSETTO BLUMOTION P. 27 CM BLUMOTION DRAWER D. 27 CM

DETTAGLIO CASSETTO INTERNO "INTIVO" FINITURA ORION GRAU
CON FRONTALE SP. 18 MM IN TINTA AI RIPIANI DISPONIBILE PER
MOBILE DA 45 E 60 CM.

DETAIL OF THE INTERNAL DRAWER "INTIVO" ORION GRAU FINISH
WITH A 18 MM THICK FRONT IN THE SAME COLOR AS THE SHELVES, AVAILABLE
FOR 45 AND 60 CM CABINET.



N.B.: per variante con luce vedi pag.16-17
 Note: for variant with light see page 16-17

MELAMINICI

COD.

mobile cantinetta a giorno
H 60 P 34
porta max.12 bottiglie
 Open wine cellar cabinet
 H 60 D 34
 max.12 bottles

N.B.: in appoggio senza piedi,
senza attaccaglie
 Note: free-standing without feet,
 without hangers

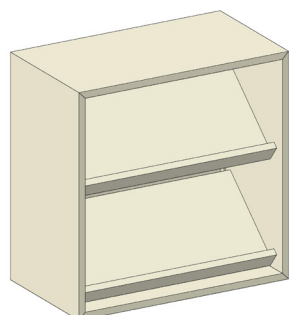

L 60 EPHW4F600

base cantinetta a giorno
H 72 P 34
porta max.12 bottiglie
con cassetto
 Open wine cellar base unit
 H 72 D 34
 max.12 bottles with drawer

N.B.: con piedi H 13
senza attaccaglie
 Note: with feet H 13,
 without hangers

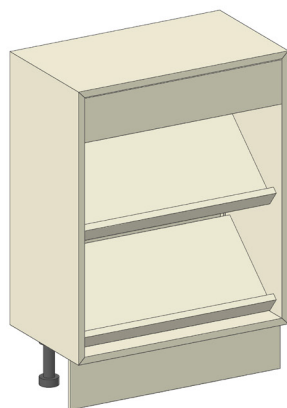

L 60 EPHW4G600

N.B.: per variante con luce vedi pag.16-17
 Note: for variant with light see page 16-17

MELAMINICI

COD.

base cantinetta a giorno
H 84 P 34
porta max.12 bottiglie
con cassetto
 Open wine cellar base unit
 H 84 D 34
 max.12 bottles with drawer

N.B.: con piedi H 6
senza attaccaglie
 Note: with feet H 6,
 without hangers

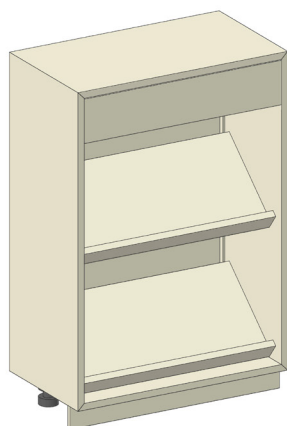

L 60 EPHW4J600

colonna cantinetta a giorno
H 132 P 34
porta max.24 bottiglie
con cassetto
 Open wine cellar column
 H 132 D 34
 max.24 bottles with drawer

N.B.: con piedi H 13
senza attaccaglie con piastra
antiribaltamento
 Note: with feet H 13
 without hangers with
 anti-tipping plat

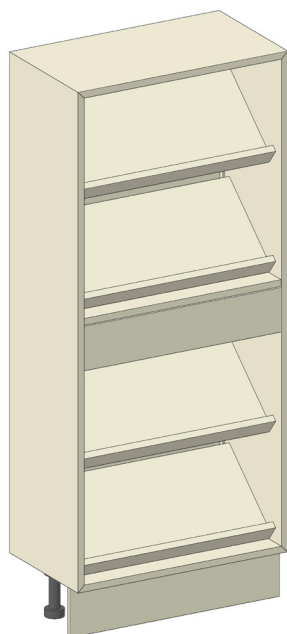

L 60 EPHW4P600

N.B.: per variante con luce vedi pag.16-17
 Note: for variant with light see page 16-17

MELAMINICI

COD.

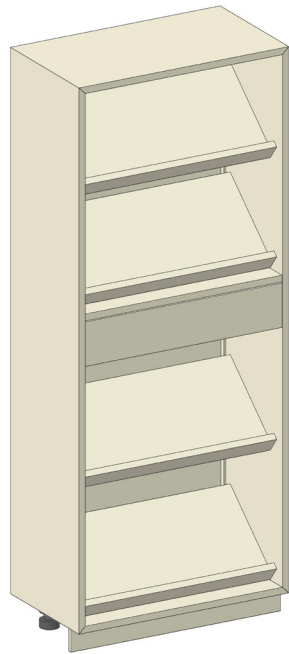

colonna cantinetta a giorno
H 144 P 34
porta max.24 bottiglie
con cassetto
 Open wine cellar column
 H 144 D 34
 max.24 bottles with drawer

N.B.: con piedi H 6
senza attaccaglie con piastra
antiribaltamento
 Note: with feet H 6
 without hangers with
 anti-tipping plat

L 60 EPHW4R600

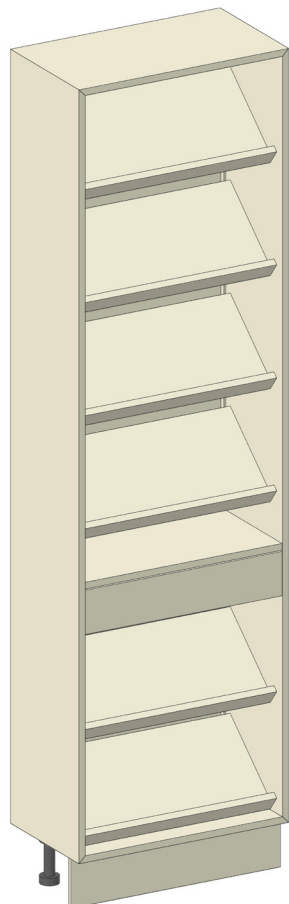

colonna cantinetta a giorno
H 204 P 34
porta max.36 bottiglie
con cassetto
 Open wine cellar column
 H 206 D 34
 max.36 bottles with drawer

N.B.: con piedi H 13
senza attaccaglie con piastra
antiribaltamento
 Note: with feet H 13
 without hangers with
 anti-tipping plat

L 60 EPHW4S600

N.B.: per variante con luce vedi pag.16-17
 Note: for variant with light see page 16-17

MELAMINICI

COD.

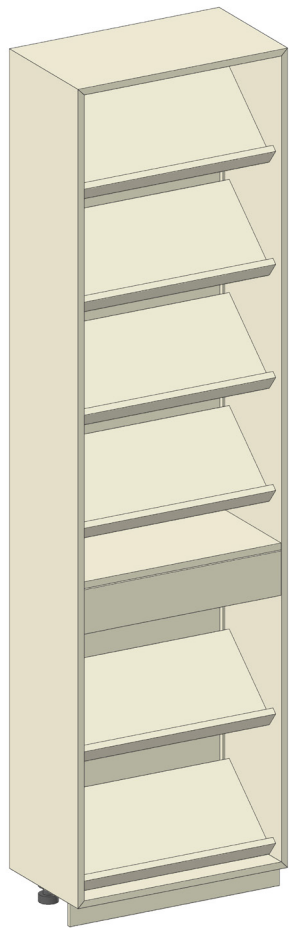

colonna cantinetta a giorno
H 216 P 34
porta max.36 bottiglie
con cassetto
 Open wine cellar column
 H 216 D 34
 max.36 bottles with drawer

N.B.: con piedi H 6
senza attaccaglie con piastra
antiribaltamento
 Note: with feet H 6
 without hangers with
 anti-tipping plat

L 60 EPHW4T600

N.B.: per variante con luce vedi pag.16-17
 Note: for variant with light see page 16-17

MELAMINICI

COD.

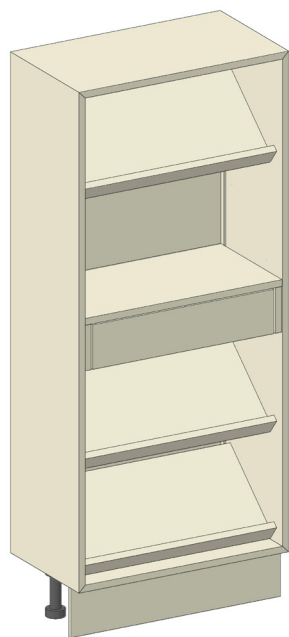

colonna cantinetta a giorno
H 132 P 34 con ripiano
porta max.18 bottiglie
con cassetto
 Open wine cellar column
 H 132 D 34 with shelf
 max.18 bottles with drawer

N.B.: con piedi H 13
senza attaccaglie con piastra
antiribaltamento
 Note: with feet H 13
 without hangers with
 anti-tipping plat

L 60 EPHW6P600

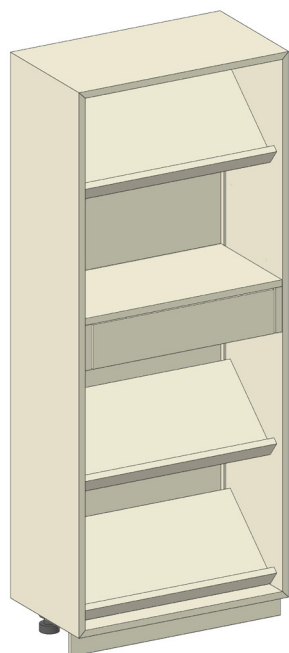

colonna cantinetta a giorno
H 144 P 34 con ripiano
porta max.18 bottiglie
con cassetto
 Open wine cellar column
 H 144 D 34 with shelf
 max.18 bottles with drawer

N.B.: con piedi H 6
senza attaccaglie con piastra
antiribaltamento
 Note: with feet H 6
 without hangers with
 anti-tipping plat

L 60 EPHWGR600

N.B.: per variante con luce vedi pag.16-17
 Note: for variant with light see page 16-17

MELAMINICI

COD.

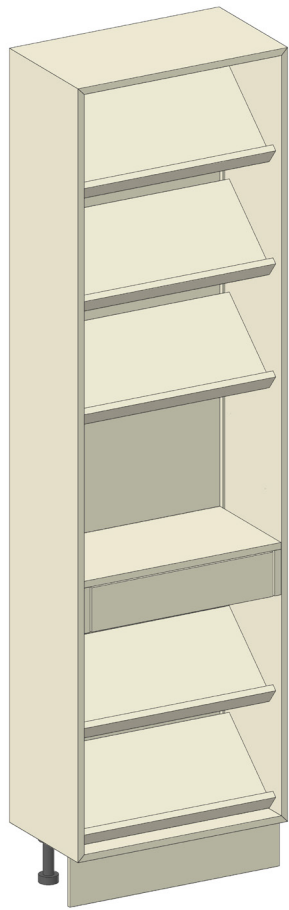

colonna cantinetta a giorno
H 204 P 34 con ripiano
porta max.30 bottiglie
con cassetto
 Open wine cellar column
 H 206 D 34 with shelf
 max.30 bottles with drawer

N.B.: con piedi H 13
senza attaccaglie con piastra
antiribaltamento
 Note: with feet H 13
 without hangers with
 anti-tipping plat

L 60 EPH-W6S600

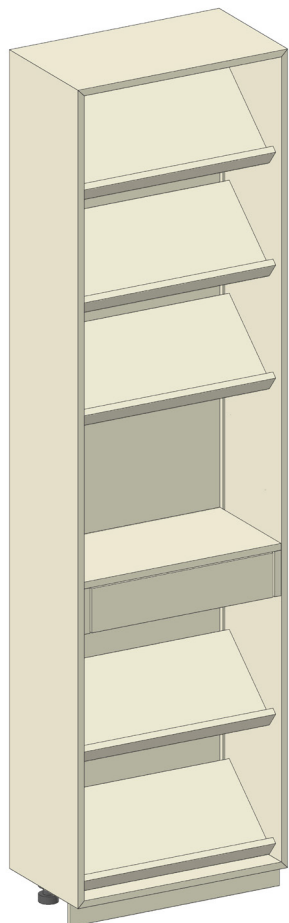

colonna cantinetta a giorno
H 216 P 34 con ripiano
porta max.30 bottiglie
con cassetto
 Open wine cellar column
 H 216 D 34 with shelf
 max.30 bottles with drawer

N.B.: con piedi H 6
senza attaccaglie con piastra
antiribaltamento
 Note: with feet H 6
 without hangers with
 anti-tipping plat

L 60 EPH-W6T600

N.B.: per variante con luce vedi pag.16-17
 Note: for variant with light see page 16-17

MELAMINICI

COD.

**mobile cantinetta con anta
 telaio alluminio H 60 P 34
 porta max.12 bottiglie**
 Wine cellar cabinet with aluminum
 frame door H 60 D 34
 max.12 bottles

**N.B.: in appoggio senza piedi,
 senza attaccaglie**
 Note: free-standing without feet,
 without hangers

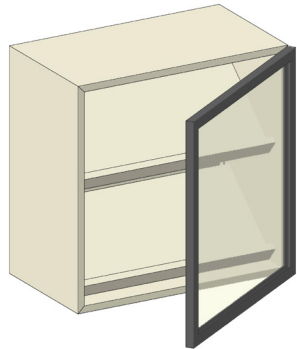

L 60 EPHW3F601/2

**base cantinetta con anta
 telaio alluminio H 72 P 34
 porta max.12 bottiglie
 con cassetto**
 Base unit wine cellar with
 aluminium frame door H 72 D 34
 max.12 bottles with drawer

**N.B.: con piedi H 13
 senza attaccaglie**
 Note: with feet H 13,
 without hangers



L 60 EPHW3G601/2

N.B.: per variante con luce vedi pag.16-17
 Note: for variant with light see page 16-17

MELAMINICI

COD.

**base cantinetta con anta
 telaio alluminio H 84 P 34
 porta max.12 bottiglie
 con cassetto**
 Base unit wine cellar with
 aluminium frame door H 84 D 34
 max.12 bottles with drawer

**N.B.: con piedi H 6
 senza attaccaglie**
 Note: with feet H 6,
 without hangers

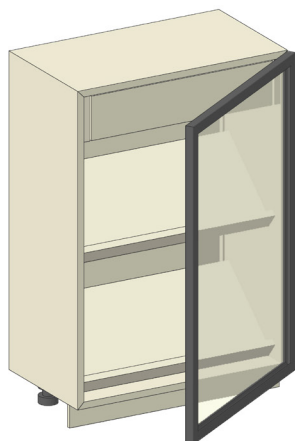

L 60 EPHW3J601/2

**colonna cantinetta con anta
 telaio alluminio H 132 P 34
 porta max.24 bottiglie
 con cassetto**
 Column wine cellar with
 aluminium frame door H 132 D 34
 max.24 bottles with drawer

**N.B.: con piedi H 13
 senza attaccaglie con piastra
 antibaltamento**
 Note: with feet H 13
 without hangers with
 anti-tipping plat



L 60 EPHW3P601/2

N.B.: per variante con luce vedi pag.16-17
 Note: for variant with light see page 16-17

MELAMINICI

COD.



**colonna cantinetta con anta
 telaio alluminio H 144 P 34
 porta max.24 bottiglie
 con cassetto**
 Column wine cellar with
 aluminium frame door H 144 D 34
 max.24 bottles with drawer

**N.B.: con piedi H 6
 senza attaccaglie con piastra
 antiribaltamento**
 Note: with feet H 6
 without hangers with
 anti-tipping plat

L 60 EPHW3R601/2



**colonna cantinetta con anta
 telaio alluminio H 204 P 34
 porta max.36 bottiglie
 con cassetto**
 Column wine cellar with
 aluminium frame door H 206 D 34
 max.36 bottles with drawer

**N.B.: con piedi H 13
 senza attaccaglie con piastra
 antiribaltamento**
 Note: with feet H 13
 without hangers with
 anti-tipping plat

L 60 EPHW3S601/2

N.B.: per variante con luce vedi pag.16-17
 Note: for variant with light see page 16-17

MELAMINICI

COD.



**colonna cantinetta con anta
 telaio alluminio H 216 P 34
 porta max.36 bottiglie
 con cassetto**
 Column wine cellar with
 aluminium frame door H 216 D 34
 max.36 bottles with drawer

**N.B.: con piedi H 6
 senza attaccaglie con piastra
 antibaltamento**
 Note: with feet H 6
 without hangers with
 anti-tipping plat

L 60 EPHW3T601/2

N.B.: per variante con luce vedi pag.16-17
 Note: for variant with light see page 16-17

MELAMINICI

COD.



**colonna cantinetta con anta
 telaio alluminio H 132 P 34
 porta max.18 bottiglie
 con cassetto e ripiano**
 Column wine cellar with
 aluminium frame door H 132 D 34
 max.18 bottles with drawer and
 shelf

**N.B.: con piedi H 13
 senza attaccaglie con piastra
 antiribaltamento**
 Note: with feet H 13
 without hangers with
 anti-tipping plat

L 60 EPHW5P601/2



**colonna cantinetta con anta
 telaio alluminio H 144 P 34
 porta max.18 bottiglie
 con cassetto e ripiano**
 Column wine cellar with
 aluminium frame door H 144 D 34
 max.18 bottles with drawer and
 shelf

**N.B.: con piedi H 6
 senza attaccaglie con piastra
 antiribaltamento**
 Note: with feet H 6
 without hangers with
 anti-tipping plat

L 60 EPHW5R601/2

N.B.: per variante con luce vedi pag.16-17
 Note: for variant with light see page 16-17

MELAMINICI

COD.

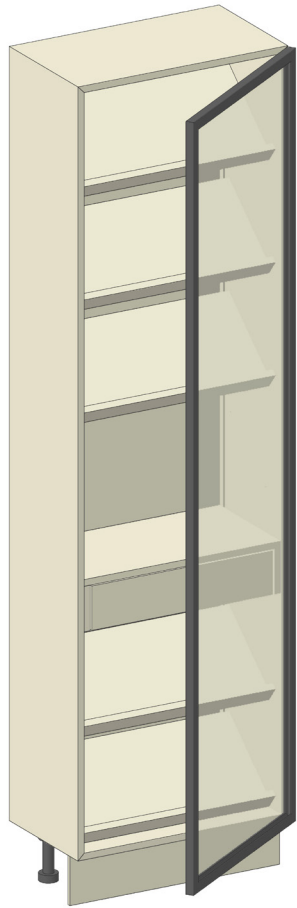

**colonna cantinetta con anta
 telaio alluminio H 204 P 34
 porta max.30 bottiglie
 con cassetto e ripiano**
 Column wine cellar with
 aluminium frame door H 206 D 34
 max.30 bottles with drawer and
 shelf

**N.B.: con piedi H 13
 senza attaccaglie con piastra
 antibaltamento**
 Note: with feet H 13
 without hangers with
 anti-tipping plat

L 60 EPHW5S601/2

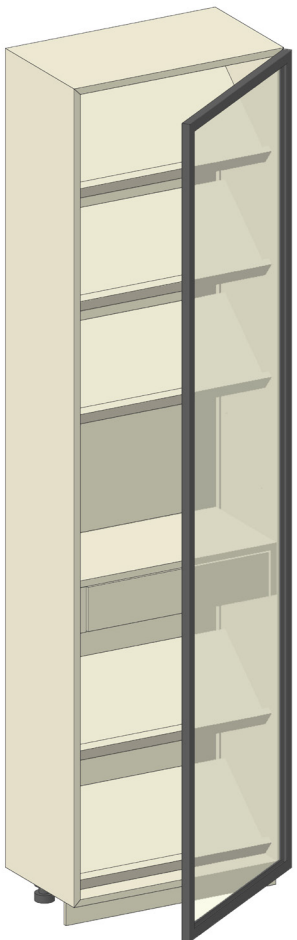

**colonna cantinetta con anta
 telaio alluminio H 216 P 34
 porta max.30 bottiglie
 con cassetto e ripiano**
 Column wine cellar with
 aluminium frame door H 216 D 34
 max.30 bottles with drawer and
 shelf

**N.B.: con piedi H 6
 senza attaccaglie con piastra
 antibaltamento**
 Note: with feet H 6
 without hangers with
 anti-tipping plat

L 60 EPHW5T601/2

LUCE MINI NOOR

MINI NOOR LIGHT



MINI NOOR

Interno pensile/colonna/elementi in folding sp. 18 o sotto mensola

Mini Noor è un profilo luminoso inclinato ad incasso particolarmente sottile (8 mm), trova applicazione in verticale integrato nei fianchi dei mobili o come sotto mensola. La sorgente LED Emotion Dual Color permette la variazione da 3000K a 4000K garantendo un comfort visivo ottimale.

Inside wall unit/column/folding unit th. 18 or under shelf

Mini Noor is a particularly thin recessed inclined light profile (8 mm), it can be applied vertically integrated into the sides of the furniture or under shelf. The Emotion Dual Color LED source allows the variation from 3000K to 4000K, guaranteeing optimal visual comfort.

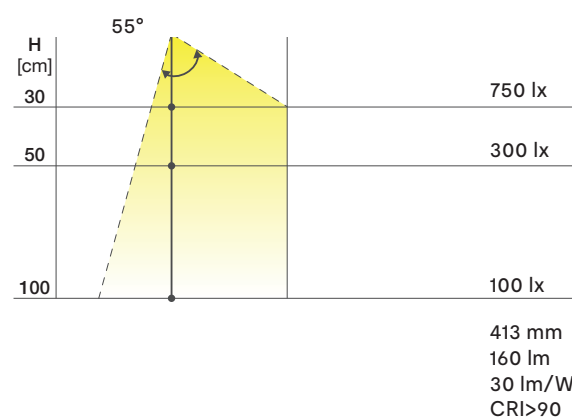



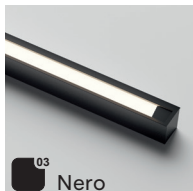
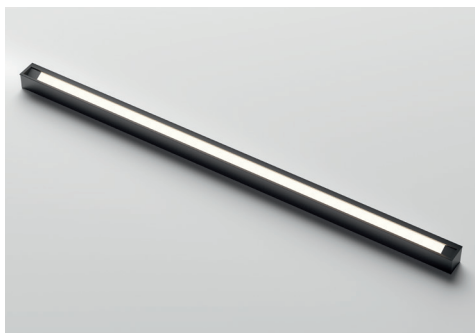

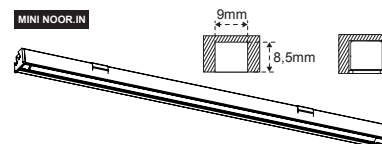
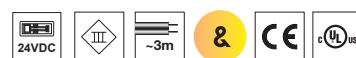

MINI NOOR



N.B.: per il montaggio della luce gli elementi in folding hanno un foro sul cielo e sul fondo
Note: folding unit have a hole on the top and the bottom for assembly



MINI NOOR.IN PER FIANCHI PENSILI/COLONNE/

	7,4 W	563 mm	3000-4000K	(H 600 mm)
	8,8 W	683 mm	3000-4000K	(H 720 mm)
	10,3 W	803 mm	3000-4000K	(H 840 mm)
	16,9 W	1283 mm	3000-4000K	(H 1320 mm)
	18,6 W	1403 mm	3000-4000K	(H 1440 mm)
	26,7 W	2003 mm	3000-4000K	(H 2040 mm)
	28,3 W	2123 mm	3000-4000K	(H 2160 mm)

codice code
08618302
08618303
08618303D
08618307
08618308
08618309
08618310

ACCESSORI OBBLIGATORI MANDATORY ACCESSORIES

- 1 Cavo alimentazione MEC DRIVER vedi pag.32 (listino luci)
 N.B.: scegliere alimentatore in base alla tipologia di mercato EUROPA o USA/CANADA
 MEC DRIVER power cable see page 32 (light price list)
 Note: choose the power supply based on the market area (EUROPE or USA/CANADA)
 - 2 Modulo alimentatore MEC DRIVER vedi pag.32 (listino luci)
 N.B.: scegliere alimentatore a seconda della potenza dei Led
 MEC DRIVER power supply module see page 32 (light price list)
 Note: choose power supply according to the LEDs power
 - 3a **Modulo DISTRIBUTOR** vedi pag.33 (listino luci)
 usato solo se le luci sono collegate ad un punto luce.
 DISTRIBUTOR module see page 33 (light price list)
 to be used only if the lights are connected to a light source
- IN ALTERNATIVA O IN AGGIUNTA AL PUNTO 3a**
 ALTERNATIVE OR ADDITION TO THE POINT
- 3b **Modulo SMART 1** vedi pag.34, (listino luci)
 per accensione comandata da radiocomando o sensore
 SMART 1 module see page 34, (light price list)
 for switching controlled by remote control or sensor
 - 3c **Modulo BLUESMART** vedi pag.35, (listino luci)
 per accensione comandata da un apposita APP per Smartphone
 BLUESMART module see page 35, (light price list)
 for switching controlled by a special APP for Smartphone



EMOTION DUAL COLOR
 La temperatura colore varia da bianco "caldo" a "naturale" (3000-4000K) variabile tramite telecomando o cambio spinotto cavo

The colour temperature varies from "warm" to "natural" white (3000-4000K) variable via remote control or cable plug change